

# Müller

## **Ultra** **GrillPower** Grill and Griddle Combo

Model: EG-2500



## USER MANUAL

---

*Your satisfaction is guaranteed. If you are not completely satisfied with our Ultra GrillPower, please let us know. We'll help make it work for you, or we'll refund your money.*

---

## IMPORTANT SAFEGUARDS

To reduce the risk of personal injury or damage to your Ultra GrillPower Grill and Griddle Combo or other property when using this product, basic safety precautions should always be followed, including the following:

- Read all instructions before assembling and using.
- Keep all packaging materials, including any plastics, out of reach of children.
- Not to be used by children.
- Close supervision is necessary when used near children or by any other persons with reduced physical, sensory, or mental capabilities.
- **Caution: This appliance is hot during operation and retains heat for some time after turning off. Do not touch hot surfaces.**
- **Always attach the Temperature Probe to the appliance first, then insert the power cord plug into the wall outlet. When finished with cooking, first turn the Temperature Dial to the "OFF" position, remove the power cord plug from the wall outlet, and then remove the Temperature Probe from the griddle.**
- Unplug from the outlet when not in use and before cleaning. Allow to cool before putting on or taking off parts and before cleaning the appliance.
- Do not operate this appliance with a damaged cord or plug or in the event the appliance malfunctions or has been damaged in any manner. Contact Mueller Customer Service.
- Do not let the cord hang over the edge of a table or a counter or touch hot surfaces.
- This product is for household use only. The appliance should not be used outdoors, placed near a hot gas or electrical burner, or placed in a heated oven.
- Do not use the appliance in any other way than its intended use.
- Always place the appliance on a heat-resistant surface, as the griddle plate will reach high temperatures.
- Do not move the appliance when in use.
- Do not cover the appliance when in use.
- Always take care when removing food after cooking as it is hot.
- Do not cook food wrapped in plastic film or polythene bags. It will cause a fire hazard.

• **Caution: Do not leave the appliance unattended when in use!**

• TO PREVENT ELECTRICAL SHOCK, do not immerse the Temperature Probe or the power cord in water or other liquids or use near washbasins or sinks. Ensure the electrical components of the appliance do not get wet, and do not use with wet hands.

• Use only the Temperature Probe supplied with this product. Using any other type of Temperature Probe may cause fire, electrical shock, or injury.

• **Caution: The Temperature Probe is a sensitive device. Use care not to drop, hit or impact the Temperature Probe against hard surfaces. Never pull on the cord of the Temperature Probe. Always grip the body of the Temperature Probe when handling.**

• The appliance is not designed for use with an external timer or a remote-control system.

• Ensure proper ventilation during use either from an open window or from a running ventilation hood. Always leave a gap of approximately 8 inches (20 cm) around the exterior of the appliance. Never use near curtains, walls, under cupboards, or other flammable materials.

• Do not store any objects on the appliance when not in use as they could scratch the griddle cooking plate or even melt or catch fire from residual heat or if the appliance is turned on inadvertently.

• **Warning: DO NOT store or use gasoline, aerosols, combustible liquids, or other easily flammable vapors or materials in the vicinity of this appliance.**

• Do not let grease or other flammable substances accumulate on this appliance. Clean regularly.

**KEEP THIS MANUAL IN A SAFE PLACE FOR FUTURE REFERENCE AND REVIEW PERIODICALLY.**

## Important Cord Information

- This appliance has a polarized electrical plug for the wall socket (one blade is wider than the other). To reduce the risk of electric shock, this plug is intended to fit into a polarized outlet only one way. If the plug does not fit fully into the outlet, reverse the plug. If it still does not fit, contact a qualified electrician. Do not attempt to modify the plug in any way.
- Connect the power supply cord to a 120V AC electrical outlet only.
- A short power-supply cord is provided to reduce the risk resulting from becoming entangled in or tripping over a longer cord. Extension cords may be used if care is properly exercised in their use. If an extension cord is used, the marked electrical rating of the extension cord should be at least as great as the electrical rating of the appliance. The extension cord should be installed so that it does not hang over the countertop or tabletop where it can be pulled on by children or tripped over unintentionally.
- If the electric circuit is overloaded with other appliances, your griddle may not function properly. It should be operated on a separate electrical circuit from other appliances.

## BEFORE FIRST USE

- 1 Clean the appliance by following the instructions in the CLEANING AND MAINTAINANCE section of this manual.
- 2 Always place the griddle on a dry, level, heat-resistant surface away from walls, cabinets, and other objects.
- 3 Before using, make sure that the voltage indicated on the rating plate of the appliance corresponds to your outlet voltage.
- 4 **When using your appliance for the first time, there may be a slight odor and smoke. This is normal and is no cause for concern.**
- 5 Always make sure the Temperature Dial is at the "OFF" position before plugging or unplugging the unit.

# GETTING TO KNOW YOUR GRIDDLE

Rated Voltage: 120V

Rated Frequency: 60Hz

Rated Power: 1000W

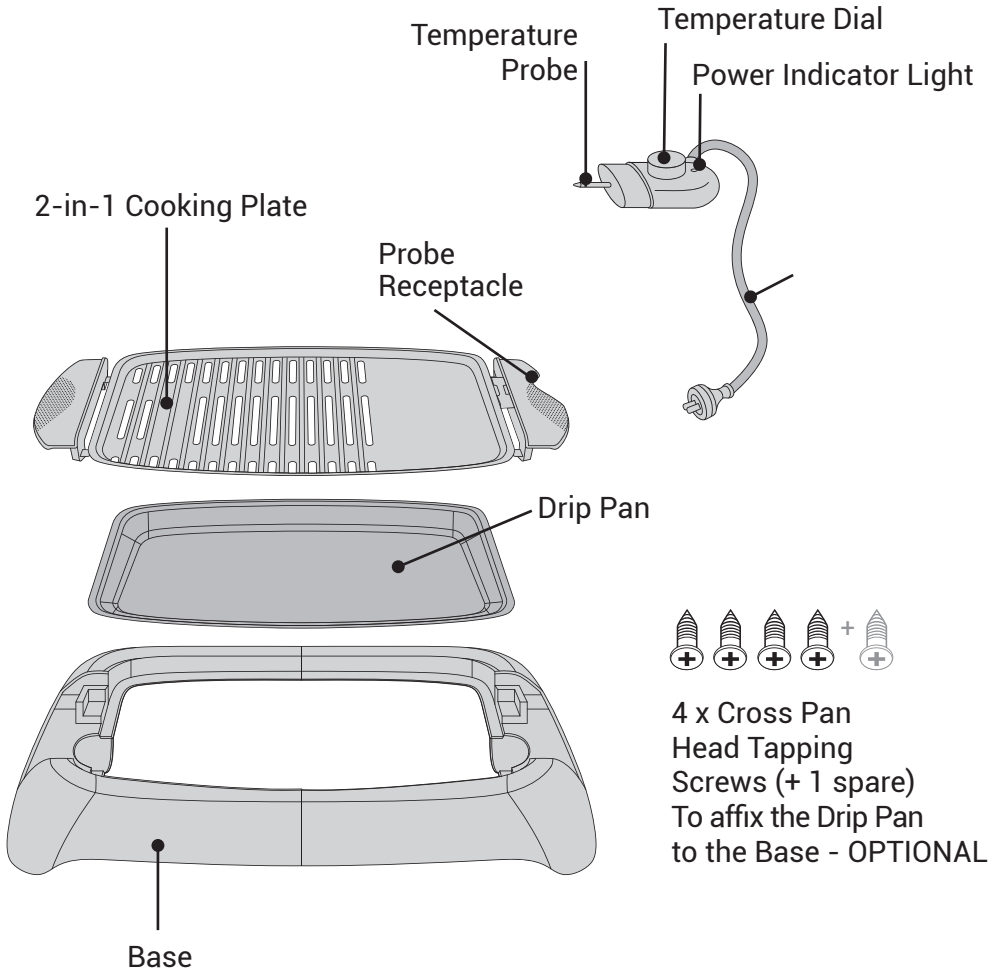

# USING YOUR GRIDDLE

## ASSEMBLING THE GRIDDLE

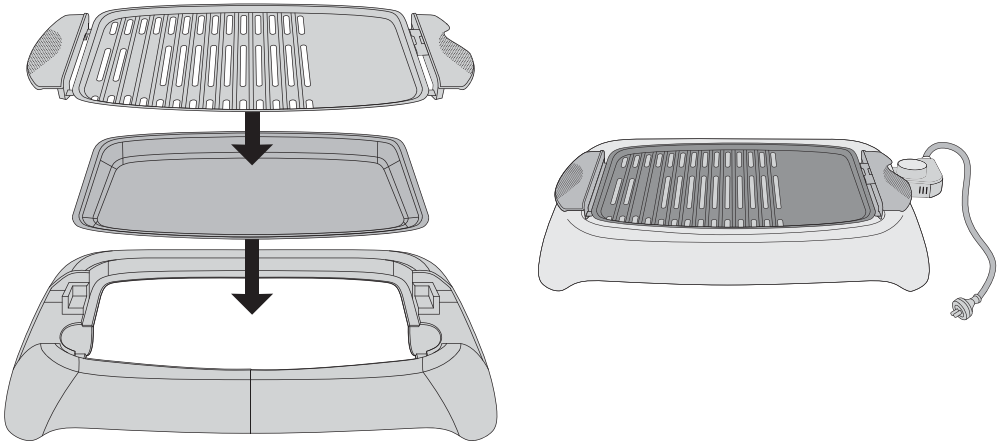

- 1 Place the Drip Pan on top of the Base.

**TIP:** To make cleaning easier and help eliminate any smoke, add water to the Drip Pan, fully covering the bottom of the pan.

- 2 Place the Cooking Plate on top of the Drip Pan.

**OPTIONAL:** For additional stability, you can secure these two parts together by attaching 4 of the provided screws into the pre-drilled holes (Note: 1 screw is spare).

- 3 Insert the Temperature Probe into the Probe Receptacle, ensuring the Temperature Dial is facing upwards and positioned at the "OFF" temperature setting. Push in thoroughly so the electrical pin of the Temperature Probe is fully inserted and secure.

**Note:** **MAKE SURE TO INSERT TEMPERATURE CONTROL PLUG ALL THE WAY IN, OR THE GRIDDLE WILL NOT TURN ON.**

- 4 Insert the power cord plug into a 120V wall outlet.

**⚠ WARNING:** Always attach the Temperature Probe to the appliance first, and then insert the power cord plug into the wall outlet.

## OPERATING THE GRIDDLE

- 1 Turn the Temperature Dial to the desired heat setting (see TEMPERATURE DIAL SETTINGS section of this manual). The Power Indicator Light will turn red indicating that the griddle is turned on. The light turns off when temperature for selected heat setting is reached (this takes approximately 5 minutes).

**NOTE:** The Power Indicator light will periodically turn on and off indicating the temperature regulating to maintain the selected heat setting.

**NOTE:** As the griddle heats up, you may hear a clicking sound; this is due to the expansion of the metal as it heats. It is normal. You may also notice this sound as the unit cools down.

- 2 Place food on the cooking plate. Because the griddle features a non-stick finish, food may be prepared with little or no oil. When using oil, always brush or spray oil onto your food, not directly onto the cooking grate.

**NOTE:** Avoid using non-stick cooking sprays as they may cause the cooking surface to become tacky.

**IMPORTANT:** Do not use metal utensils as they may scratch the non-stick surface. Use nylon, plastic, wooden, or rubber utensils. Never cut food directly on the griddle.

- 3 Turn the Temperature Dial to the "OFF" position when cooking is completed. Unplug the power cord plug from the wall outlet, and then unplug the Temperature Probe from the griddle. Allow the griddle to cool completely before disassembling it for cleaning.

**Caution:** Be sure liquid has cooled before removing the Drip Pan.

 **WARNING:** When finished with cooking, first turn the Temperature Dial to "OFF" position, then remove the power cord plug from the wall outlet, and then remove the Temperature Probe from the griddle.

### TEMPERATURE DIAL SETTINGS

SETTING	WARM	1	2	3	4	5
APPROXIMATE TEMPERATURE	170°F 75°C	240°F 115°C	275°F 135°C	310°F 155°C	340°F 170°C	420°F 215°C







## COOKING HINTS AND TIPS

- Use tender cuts of meat.
- Better cooking results will be achieved with boneless cuts of meat, chicken, and fish.
- Marinate tougher cuts of meat to tenderize them before cooking.
- To avoid drying out meat and fish, do not pierce center with a utensil.
- Cut edge of meat in several places to prevent curling.
- When cooking fish or chicken breast fillets, tuck extremely thin parts under to prevent overcooking.
- Apply sugar-based sauces such as commercial barbecue sauces to the griddle surface only during the latter stages of cooking, to prevent charring.
- Adjust heat setting gradually and only as necessary. Cooking foods at too high a temperature can cause them to dry out.
- If food is undercooked when removed from the griddle, simply return to the griddle for additional cooking time.
- Some foods such as eggs and pancakes cook better if the non-stick griddle surface is conditioned with cooking oils before preheating. If necessary, remove excess oil with a paper towel.

## CLEANING AND MAINTAINANCE

Always clean your appliance after each use to prevent build up.

### WARNING!

-  Always allow your griddle to cool completely before handling and washing.
-  Never immerse your appliance in water or other liquids. Keep the power cord and the Temperature Probe away from any liquids.
-  Always disconnect the power cord plug from the wall outlet and the Temperature Probe from the Probe Receptacle before cleaning.
-  The griddle is not dishwasher safe.

### TEMPERATURE PROBE

- Remove the Temperature Probe, wipe with a damp cloth and dry thoroughly. **Make sure not to expose the Probe Receptacle to the water!**

DO NOT WASH THE TEMPERATURE PROBE OR THE POWER PLUG, OR PLACE IN DISHWASHER.

**CAUTION: Temperature control probe and probe receptacle must always be completely dry before use.**

### COOKING PLATE

- Use paper towels to wipe off any excess grease or residue left on the Cooking Plate. You may use a wooden or plastic spatula to scrape off any remaining food residue. Lift and remove the Cooking Plate from the base. Wipe the surface clean under warm running water with a soft cloth.



**Caution! Make sure not to expose the Probe Receptacle to the water!**

- Dry the Cooking Plate thoroughly with a clean and dry cloth or let air dry.

## **DRIP PAN**

**Caution: Be sure liquid has cooled before removing the Drip Pan.**

- Lift up and empty the Drip Pan.
- Wipe the extra grease with paper towels.
- Wash the Drip Pan in warm, soapy water.

## **BASE**

- Use a damp cloth or sponge to wipe the base.
- If needed, wash the base in warm, soapy water.

Make sure that the griddle is completely dry before using it again or storing it. Store in a clean, dry place. Store carefully, so as not to scratch the griddle cooking plate. Never store the griddle while it is hot or leave plugged in. Never wrap the cord tightly around the appliance as this could cause the cord to fray and break.

** IMPORTANT: Avoid using harsh abrasives, oven cleaners, or scouring pads to maintain the protective coating on the griddle. Wooden, silicone, heat-resistant nylon utensils or soft abrasive pads/brushes may be used.**

# Müller



## Your purchase comes with a 100% satisfaction guarantee from Müller

---

If you are not happy with the product for any reason, please contact us at [support@muellerdirect.com](mailto:support@muellerdirect.com) or **888-632-9981** with your feedback or questions, and we will do our best to make things right for you!

### **Müller USA**

---

168 Mason Way Unit #4A, City of Industry, CA 91746

Telephone: (888) 632-9981

E-mail: [support@muellerdirect.com](mailto:support@muellerdirect.com)

Web: [www.muellerhome.us](http://www.muellerhome.us)